

ASSEMBLY and DISASSEMBLY

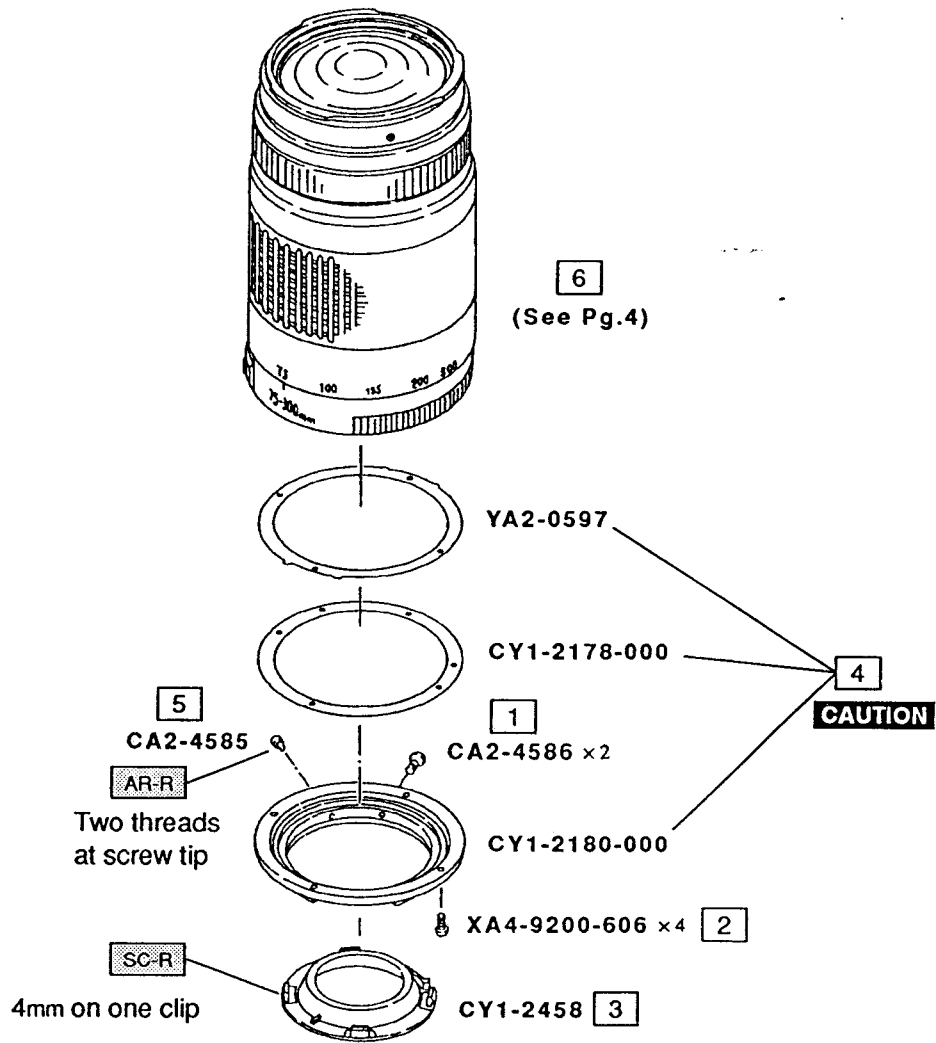

Fig. 1 Assembly and Disassembly - 1

Table 1 Expendables List

Expendable	Part No.	Symbol
Double-sided Tape	CY9-4033	DO
Arontite L	CY9-8008	AR-L
Arontite R	CY9-8009	AR-R
Screw Lock, Red	CY9-8011	SC-R
Water Based Bond 7	CY9-8015	WA
Electro-lube 2GX	CY9-8039	ELE
MoS ₂ Paste	CY9-8067	PLXX
Vinylole	CY9-8076	VI
Floil G31KB	CY9-8092	FL31
Floil GP1-MA	CY9-8096	FL1
Floil G92KB	CY9-8097	FL92
Photolub AC-13	CY9-8104	AC13

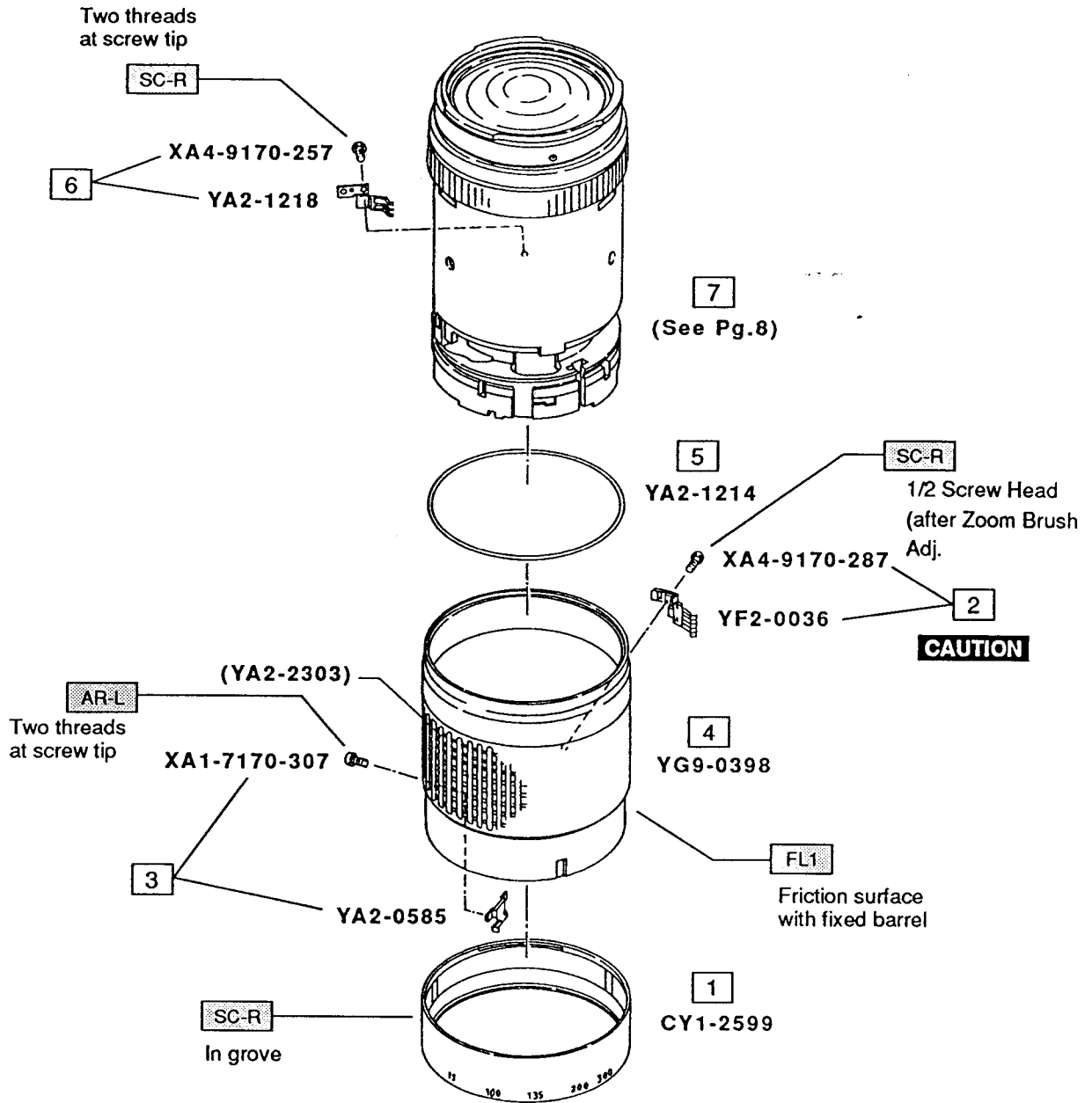

Fig. 5 Assembly and Disassembly - 3

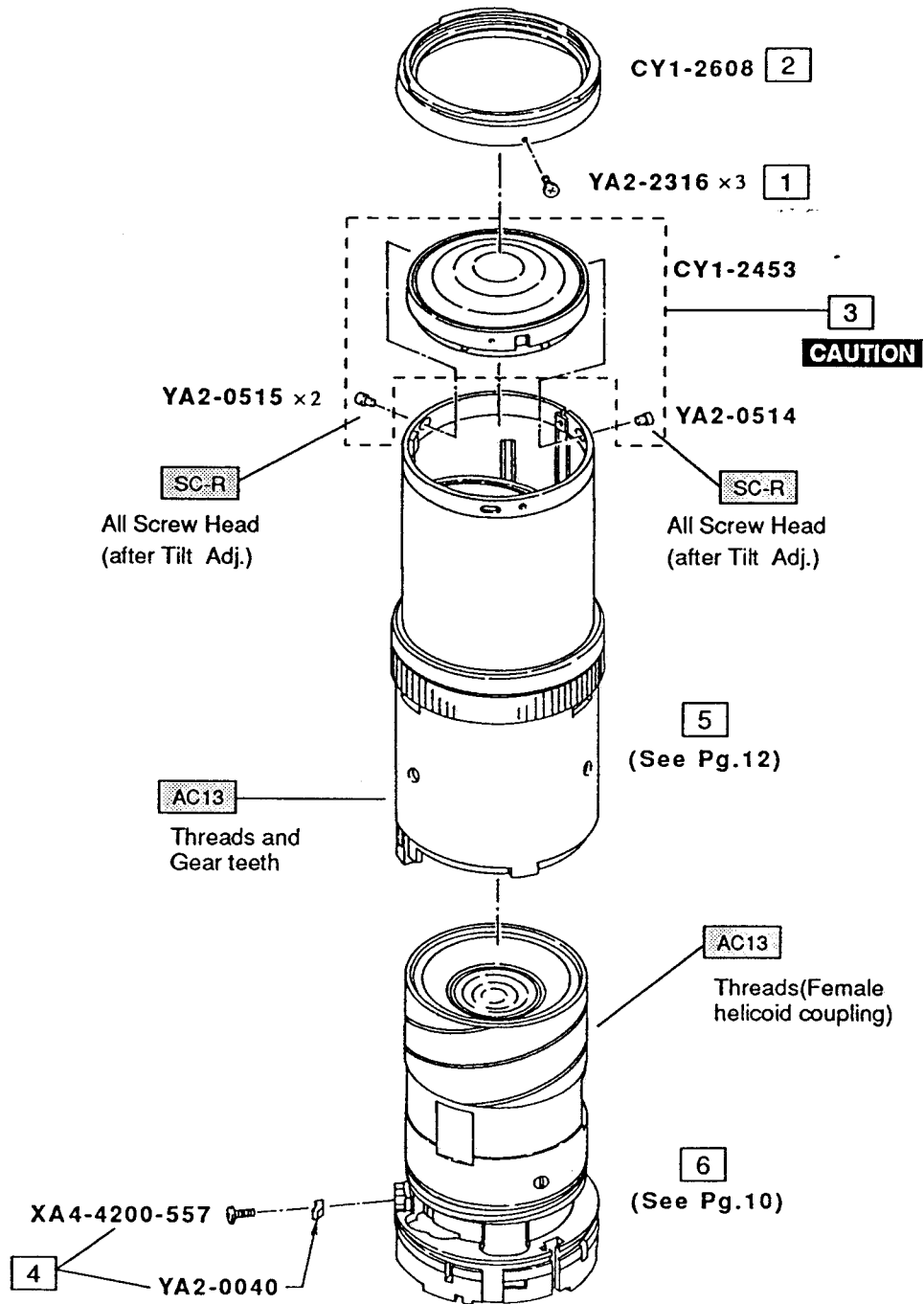

Fig. 6 Assembly and Disassembly - 4

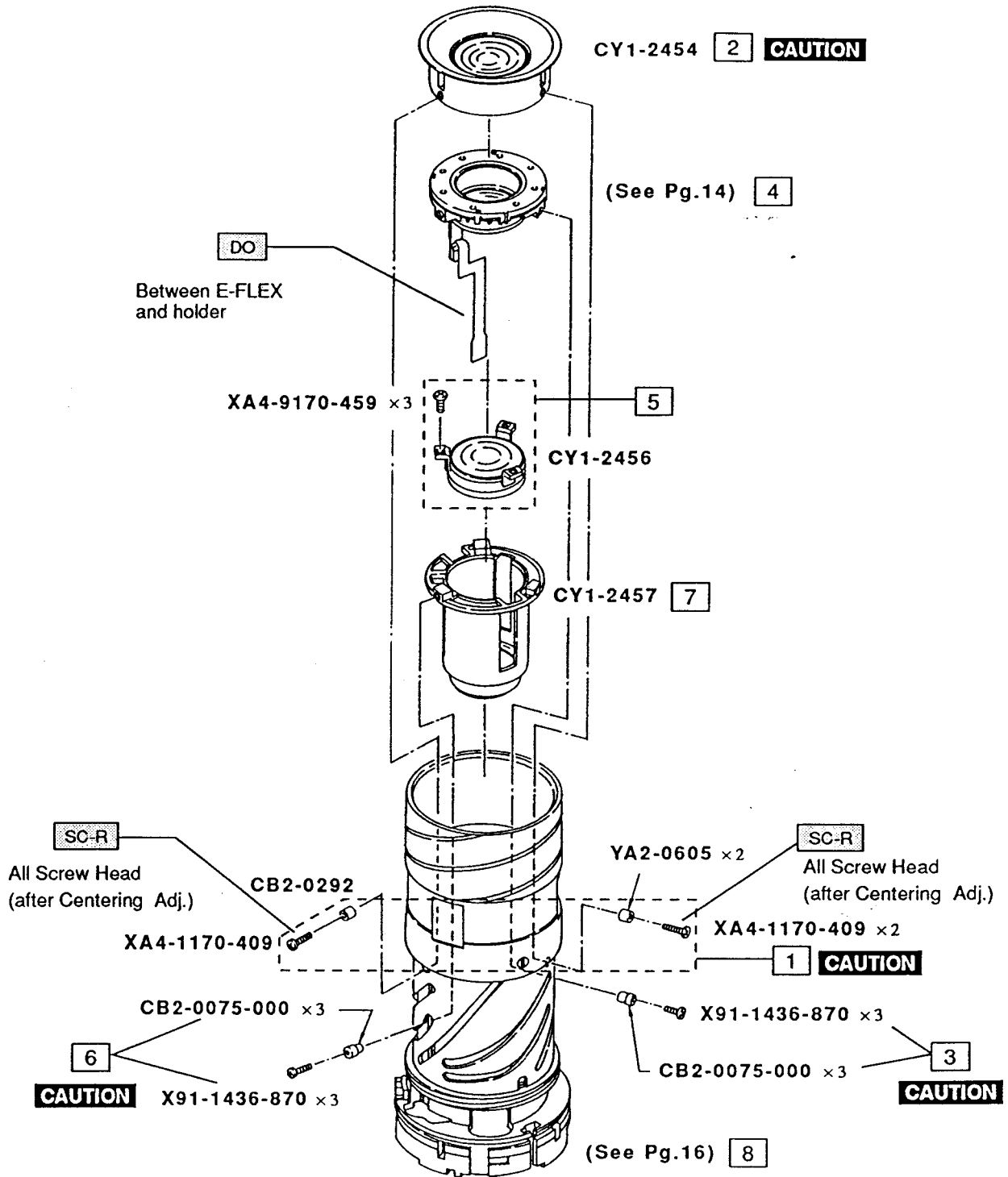

Fig. 7 Assembly and Disassembly - 5

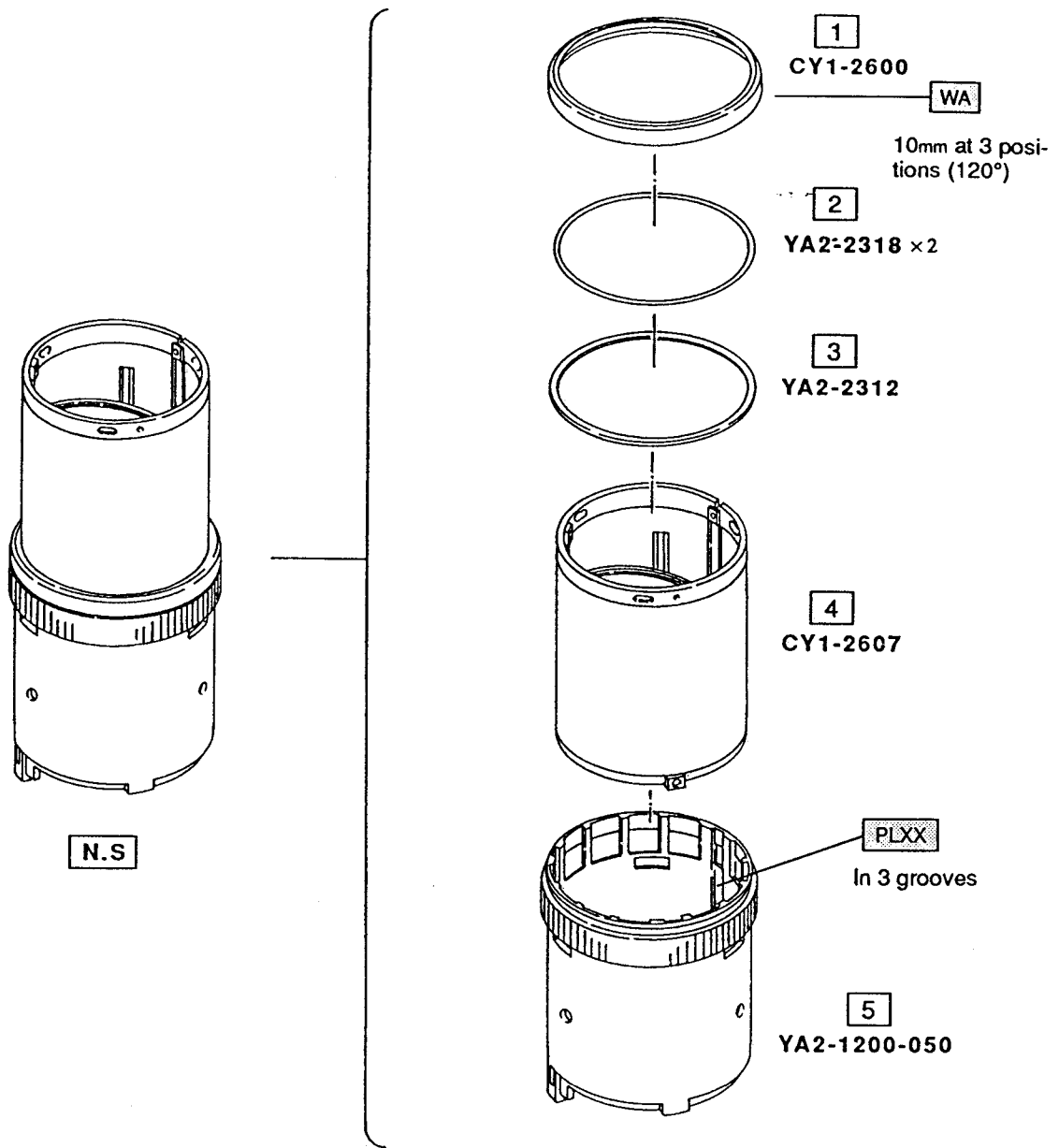

Fig. 9 Assembly and Disassembly - 6

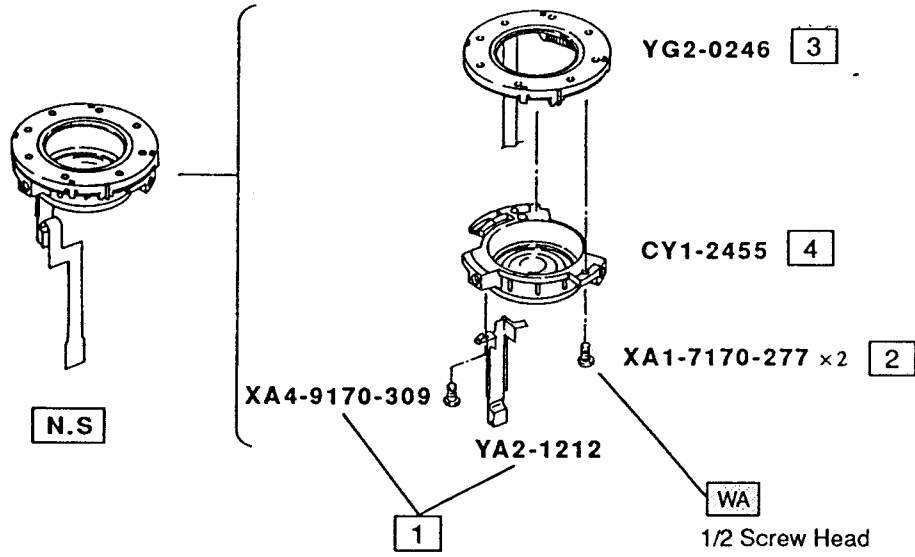

Fig. 10 Assembly and Disassembly - 7

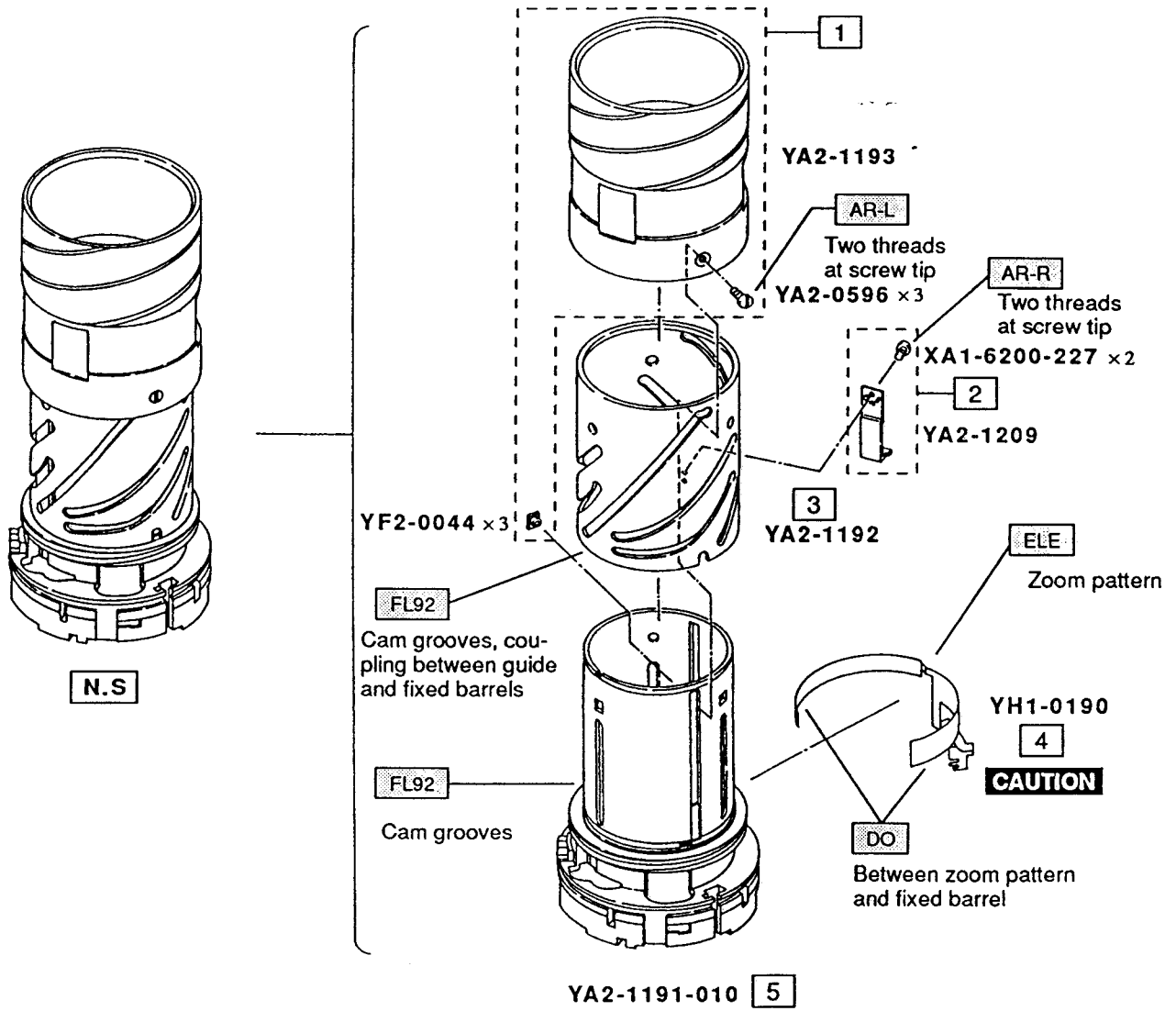

Fig. 11 Assembly and Disassembly - 8

PARTS LIST

NEW	PARTS NO.	CLASS	QTY	DESCRIPTION	PAGE
	CA2-4585-000	E	1	SCREW, MOUNT STOPPER	ストッパービス 2
	CA2-4586-000	E	2	SCREW	接点ブロック止めビス 2
	CB2-0075-000(XXX)	E	6	COLLAR, FOCUSING	Hコロ1 10
	CB2-0292-000	E	1	COLLAR, ECCENTRIC	第2群コロ 10
	CH1-0632-000	E	1	M-FLX	M-FLX 4
	CY1-2178-000(XXX)	E	1	WASHER, MOUNT	マウントワッシャー 2
	CY1-2180-000(XXX)	C	1	MOUNT, LENS	レンズマウント 2
	CY1-2453-000	E	1	LENS G1/2.3 W/BARREL	第1群ユニット 8
	CY1-2454-000	E	1	LENS G4.5 W/BARREL	第2群ユニット 10
	CY1-2455-000	E	1	LENS G6/7 W/FRAME	第3群ユニット 14
	CY1-2456-000	E	1	LENS G8/9.10 W/BARREL	第4群ユニット 10
	CY1-2457-000	E	1	LENS G11.12/13 W/BARREL	第5群ユニット 10
	CY1-2458-000	E	1	COVER, BACK	裏蓋 2
*	CY1-2599-000	D	1	RING, ZOOMING SCALE	ズーム目盛環 6
*	CY1-2600-000	C	1	RING, NAME	EOSリング 12
*	CY1-2601-000	C	1	AMSWITCH ASS'Y	スイッチカバーユニット 4
*	CY1-2605-000	B	1	AF DRIVE UNIT	フォーカスユニット 4
*	CY1-2607-000	D	1	OUTER HELICOID	メスヘリコイド筒 12
*	CY1-2608-000	C	1	RING, FRONT	フィルター枠 8
	X91-1436-870		6	SCREW, CROSS-RECESS, PH	10
	XA1-6200-227		2	SCREW, CROSS-RECESS, PH	16
*	XA1-7170-277		2	SCREW, CROSS-RECESS, PH	14
	XA1-7170-307		1	SCREW, CROSS-RECESS, PH	6
	XA4-1170-409		3	SCREW, CROSS-RECESS, PH	10
	XA4-4200-557		3	SCREW, CROSS-RECESS, PH	4,8
	XA4-9170-257		1	SCREW, CROSS-RECESS, PH	6
	XA4-9170-287		1	SCREW, CROSS-RECESS, PH	6
	XA4-9170-309		1	SCREW, CROSS-RECESS, PH	14
	XA4-9170-459		3	SCREW, CROSS-RECESS, PH	10
	XA4-9200-606		4	SCREW, CROSS-RECESS, PH	2
	YA2-0040-000	E	1	STOPPER, FOCUS	フォーカスストッパー 8
	YA2-0514-000	E	1	PIN	1群ピン 8
	YA2-0515-000	E	2	PIN, ADJUSTING	調整ピン 8
	YA2-0518-000	D	2	RUBBER, FRICTION	ズーム味出しゴム 4
	YA2-0585-000	E	1	STOPPER, KEY	ズーム連結板2 6
	YA2-0596-000	F	3	SCREW, CROSS-RECESS, PH	直進筒軸ビス 16
	YA2-0597-000	E	1	WASHER, MOUNT	ピントワッシャー 2
	YA2-0605-000	D	2	COLLAR	コロ 10
	YA2-1191-010	E	1	BARREL, FIXED	固定筒 16
	YA2-1192-000	E	1	BARREL, ZOOMING CAM	カム筒 16

PARTS LIST

NEW	PARTS NO.	CLASS	QTY	DESCRIPTION	PAGE	
	YA2-1193-000	E	1	INNER HELICOID	直進筒	16
	YA2-1200-050	E	1	RING, FOCUSING	フォーカスリング	12
	YA2-1209-000	E	1	KEY	ズーム連結板1	16
	YA2-1212-000	E	1	HOLDER, EMD-FLX	E-FLX保持台2	14
	YA2-1214-000	E	1	SHIELD, DUST	防止板2	6
	YA2-1218-000	D	1	BRUSH, FOCUSING	フォーカスブラシ	6
	YA2-1219-000	D	1	CONTACT ASS'Y	接点ブロック	4
*	YA2-2303-000	C	1	RING, RUBBER	ズームゴムリング	6
	YA2-2312-000	D	1	RING, REINFORCEMENT	補強板	12
*	YA2-2316-000	F	3	SCREW, CROSS-RECESS, PH	外観ビス	8
*	YA2-2318-000	C	2	WASHER, DUST SHIELD	防止板	12
	YF2-0036-000	D	1	BRUSH, ZOOMING	ズームブラシ	6
	YF2-0044-000	E	3	KEY	1群直進キー	16
*	YG2-0246-000	C	1	POWER DIAPHRAGM UNIT	EMDユニット	14
*	YG9-0396-000	D	1	RING, INDEX	外装環ユニット	4
*	YG9-0398-000	C	1	RING, ZOOM	ズーム操作環ユニット	6
*	YG9-0433-000	B	1	PCB ASS'Y, MAIN	メイン基板ユニット	4
	YH1-0190-000	D	1	Z-FLX	Z-FLX	16

CANON LENS EF 75-300mm 1:4.0-5.6 II USM

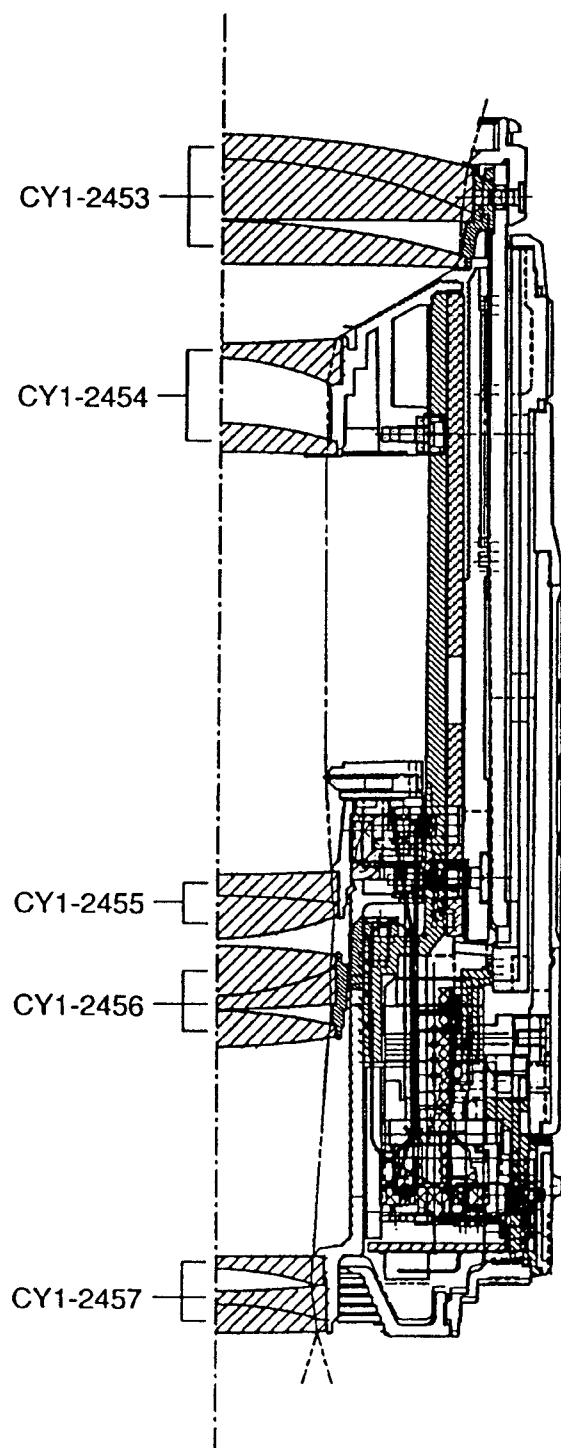

Fig. 13 Cross-section